

# USB WiFi Adapter for Blu-ray Disc™/DVD Player WUS-ND12B

## OWNER'S MANUAL

For USA

### Before Use

#### Precautions for use

- Keep this product and this accessory out of the reach of children.
- This product is for use with the Unique 1.0 m / 3.281 ft extension cable only.
- Do not place this product in a location near a heat source, or a place subject to direct sunlight. Doing so may cause a distortion or malfunction.
- Keep this product away from flammable objects or naked flame sources (such as lighted candles).
- Do not repair this product by yourself. Refer servicing to qualified personnel only.

#### Introduction

This product is the wireless adapter with a USB connector. It is for use with Blu-ray Disc™ Player only. You can use this product by connecting it to the USB port of a system.

### USA-Federal Communications Commission Statement

#### FCC Compliance Statement

This device complies with Part 15 of the FCC Rules.

Operation is subject to the following two conditions:

- (1) This device may not cause harmful interference, and
- (2) This device must accept any interference received, including interference that may cause undesired operation.

**Interference:** This equipment has been tested and found to comply with the limits for a Class B digital device, pursuant to Part 15 of the FCC Rules. These limits are designed to provide reasonable protection against harmful interference in a residential installation. This equipment generates, uses and can radiate radio frequency energy and, if not installed and used in accordance with the instructions, may cause harmful interference to radio communications. However, there is no guarantee that interference will not occur in a particular installation. If this equipment does cause harmful interference to radio or television reception, which can be determined by turning the equipment off and on, the user is encouraged to try to correct the interference by one of the following measures:

- Reorient or relocate the receiving antenna.
- Increase the separation between the equipment and receiver.
- Connect the equipment into an outlet on a circuit different from that to which the receiver is connected.
- Consult the dealer or an experienced radio/TV technician for help.

#### Wireless Radio

For product available in the USA and Canada market, only channel 1–11 can be operated. Selection of other channels is not possible. The device could automatically discontinue transmission in case of absence of information to transmit, or operational failure. Note that this is not intended to prohibit transmission of control or signaling information or the use of repetitive codes where required by the technology.

### Configuring a wireless Internet connection

This section describes how to configure the Blu-ray Disc™ player for accessing the Internet via a WiFi connection. The procedure for connecting to a wireless network depends on various network parameters. Read the following configuration methods to determine which instructions to use to connect to your network.

#### LED Indicator

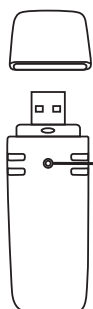

LED indicator

LED	Behavior
Inactive	Turned Off
Active	Keep blinking

#### Standards Compliance

- Compatible with IEEE 802.11a/b/g and 802.11n.

#### Note

- The location where the transmission is most effective differs depending on the usage environment. In this case, use the Unique 1.0 m / 3.281 ft extension cable.
- Check precautions and instructions about the usage location of the product. For details, refer to the operating instructions of each product.

#### Accessories

- USB Wireless LAN Adapter (1)
- Unique 1.0 m / 3.281 ft extension cable (1)
- Operating Instructions (this manual) (1)

If this device is going to be operated in 5.15–5.25GHz frequency range, then it is restricted in indoor environment only.

**Important:** Any changes or modifications not expressly approved by the party responsible for compliance could void the user's authority to operate this equipment.

This device and its antenna(s) must not be co-located or operating in conjunction with any other antenna or transmitter.

**FCC Radiation Exposure Statement:** This equipment complies with FCC radiation exposure limits set forth for an uncontrolled environment. This equipment should be installed and operated with minimum distance 20 cm between the radiator & your body.

#### Specifications

Standards Compliance:

IEEE 802.11a/b/g/n

Host Interface:

USB 2.0

Authentication Mode:

WPAPSK, WPA2PSK

Encryption Type:

WEP, TKIP, AES

Frequency and Channel\*1:

2.412 GHz – 2.462 GHz [CH1 – 11]

5.15 GHz – 5.25 GHz [CH36 – 48]

5.25 GHz – 5.35 GHz [CH52 – 64]

5.47 GHz – 5.725 GHz [CH100 – 140]

5.725 GHz – 5.85 GHz [CH149 – 165]

Power Consumption:

2.2 W

Mass (Approx.):

USB Wireless LAN Adapter: 15 g

Dimensions (Approx.) (w × h × d):

USB Wireless LAN Adapter:

73.3 mm × 26.6 mm × 10.5 mm

Design and specifications are subject to change without notice.

\*1 The frequency and channel differ depending on the area.

#### Wireless Setting

If no Ethernet cable is connected to the ETHERNET jack of your player, you can connect this USB WiFi adapter to your player and then select "Interface -> Wireless" in the Network setting menu and the following screen appears:

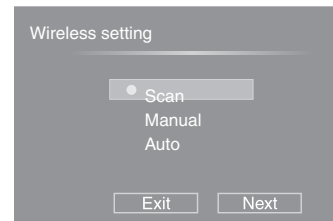

#### 1. Scan mode (select the Wireless Network which you scanned)

- 1) Press ▲ / ▼ to select **Scan**, then press OK. A list of existing wireless networks near the Blu-ray Disc™ player will appear (It may take several seconds for this list to be created). For example:

SSID	Security	Signal Strength
VODTEST	WPA2(AES)	80%
ChinaNet	WPA(TKIP)	50%
TP-LINK	NONE	46%

- 2) Press ▲ / ▼ to select the desired wireless network, and press OK to confirm.

#### a. If the Blu-ray Disc™ player is connected to an Unencrypted Wireless Network, it will display "NONE" in the Security list and there is NO need to enter the password.

If the wireless network is functioning, a message "Connection success and IP is obtained" will appear on the TV.

- 3) Press OK to close the message. The Blu-ray™ disc player is now connected to the network. From now on, when you turn on the player, it will automatically connect to the network; there is no need to repeat these steps again.

#### Note:

- If you do not see this message, the Blu-ray Disc™ player was not able to connect to the network.

#### b. If the Blu-ray Disc™ player is connected to an Encrypted Wireless Network, a menu similar to the following will appear:

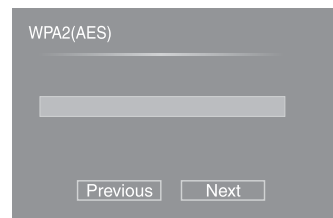

- 3) Press OK to activate the on-screen keyboard. Carefully enter the network password by using the ▲, ▼, ◀, ▶ to highlight the desired letter on the keyboard, and then press OK. (If you make a mistake, use ▲, ▼, ◀, ▶ to highlight **Back** on the keyboard and press OK to erase the mistake. Or highlight **Clear** on the keyboard and press OK to clear them, then enter again.)



- 4) Use ▲, ▼, ◀, ▶ to highlight **Enter** on the keyboard, and then press OK.

If the wireless network is functioning, a message "Connection success and IP is obtained" will appear on the TV.

- 5) Press OK to close the message. The Blu-ray™ disc player is now connected to the network.

From now on, when you turn on the player, it will automatically connect to the network; there is no need to repeat these steps again.

#### Notes:

- If you do not see this message, the Blu-ray Disc™ player was not able to connect to the network.
- If the wireless network is encrypted using an unsupported encryption, you cannot connect to the network. You must change the router's encryption type before proceeding.

#### 2. Manual mode (connection to the Wireless Network via your input SSID)

- 1) Press ▲ / ▼ to select **Auto**, then press OK.

The following screen appears.



- 2) Press OK to activate the on-screen keyboard and enter the SSID you desired.

- 3) Use ▲, ▼, ◀, ▶ to highlight **Enter** on the keyboard, and then press OK.

- 4) Follow the instructions to continue operating the connection.

#### 3. Auto (connection to the Wireless Networks Using WPS <Wi-Fi Protected Setup>)

- 1) Press ▲ / ▼ to select **Auto**, then press OK.

- 2) Use ▲ / ▼ to select **PBC** or **PIN**.

- 3) Follow the instructions to continue operating the connection.

### **Industry Canada statement:**

This device complies with RSS-210 of the Industry Canada Rules. Operation is subject to the following two conditions: (1) This device may not cause harmful interference, and (2) this device must accept any interference received, including interference that may cause undesired operation.

Ce dispositif est conforme à la norme CNR-210 d'Industrie Canada applicable aux appareils radio exempts de licence. Son fonctionnement est sujet aux deux conditions suivantes: (1) le dispositif ne doit pas produire de brouillage préjudiciable, et (2) ce dispositif doit accepter tout brouillage reçu, y compris un brouillage susceptible de provoquer un fonctionnement indésirable.

### **Caution :**

- (i) the device for operation in the band 5150-5250 MHz is only for indoor use to reduce the potential for harmful interference to co-channel mobile satellite systems;
- (ii) the maximum antenna gain permitted for devices in the bands 5250-5350 MHz and 5470-5725 MHz shall comply with the e.i.r.p. limit; and
- (iii) the maximum antenna gain permitted for devices in the band 5725-5850 MHz shall comply with the e.i.r.p. limits specified for point-to-point and non point-to-point operation as appropriate.
- (iv) Users should also be advised that high-power radars are allocated as primary users (i.e. priority users) of the bands 5250-5350 MHz and 5650-5850 MHz and that these radars could cause interference and/or damage to LE-LAN devices.

### **Avertissement:**

Le guide d'utilisation des dispositifs pour réseaux locaux doit inclure des instructions précises sur les restrictions susmentionnées, notamment :

- (i) les dispositifs fonctionnant dans la bande 5150-5250 MHz sont réservés uniquement pour une utilisation à l'intérieur afin de réduire les risques de brouillage préjudiciable aux systèmes de satellites mobiles utilisant les mêmes canaux;
- (ii) le gain maximal d'antenne permis pour les dispositifs utilisant les bandes 5250-5350 MHz et 5470-5725 MHz doit se conformer à la limite de p.i.r.e.;
- (iii) le gain maximal d'antenne permis (pour les dispositifs utilisant la bande 5725-5850 MHz) doit se conformer à la limite de p.i.r.e. spécifiée pour l'exploitation point à point et non point à point, selon le cas.

(iv) De plus, les utilisateurs devraient aussi être avisés que les utilisateurs de radars de haute puissance sont désignés utilisateurs principaux (c.-à-d., qu'ils ont la priorité) pour les bandes 5250-5350 MHz et 5650-5850 MHz et que ces radars pourraient causer du brouillage et/ou des dommages aux dispositifs LAN-EL.

**Radiation Exposure Statement:**

This equipment complies with IC radiation exposure limits set forth for an uncontrolled environment. This equipment should be installed and operated with minimum distance 20cm between the radiator & your body.

**Déclaration d'exposition aux radiations:**

Cet équipement est conforme aux limites d'exposition aux rayonnements IC établies pour un environnement non contrôlé. Cet équipement doit être installé et utilisé avec un minimum de 20 cm de distance entre la source de rayonnement et votre corps.